

LEGEND

- = EXISTING IRON PIN & CAP SRW # 3018
- = EXISTING MONUMENT AS DESCRIBED

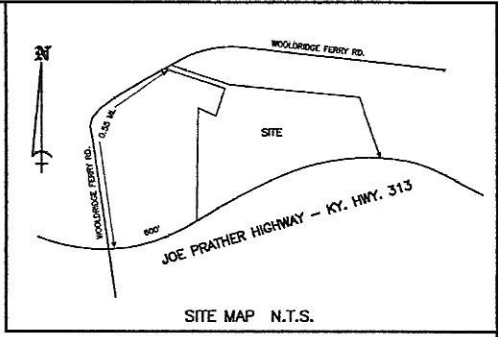

BEING A PART OF THE  
 STEPHEN R. & SUSAN D. WURZEL  
 PROPERTY RECORDED IN  
 D.B. 815 PG. 228  
 MORE PARTICULARLY A PART OF  
 TRACTS 1 & 2 IN  
 D.B. 815 PG. 231  
 66.721 AC.

TOTAL COMBINED AREA  
 67.334 AC.

JOE PRATHER HIGHWAY - KY. HWY. 313 VARIABLE R/W

Doc ID: 009821510001  
 Kind: SURVEY  
 Recorded: 07/21/2015 at 08:43:41 AM  
 Receipt#: 2015-00008537  
 Page 1 of 1  
 Fees: \$20.00  
 Hardin County Clerk  
 Debbie Donnelly Clerk  
 File 5784

Debbie Donnelly, County Clerk of  
 Hardin County, Kentucky, hereby certify  
 that the foregoing instrument has been  
 duly recorded in my office.  
 By ANITA G GOODIN, dc

OWNERS CERTIFICATE

I DO HEREBY CERTIFY THAT I AM THE OWNER OF  
 RECORD OF THE PROPERTY SHOWN HEREON AS  
 RECORDED IN D.B. 815 PG. 228 & D.B. 833 PG. 478  
 IN THE HARDIN COUNTY CLERK'S OFFICE  
 AND DO HEREBY ADOPT THIS SURVEY.

*Stephen R. Wurzel*  
 STEPHEN R. & SUSAN D. WURZEL  
*Susan D. Wurzel*

LAND SURVEYOR'S CERTIFICATE

I DO HEREBY CERTIFY THAT THE SURVEY SHOWN  
 HEREON WAS DONE UNDER MY SUPERVISION BY THE  
 METHOD OF RANDOM TRAVERSE WITH SIDESHOTS. THE  
 UNADJUSTED PRECISION RATIO OF THE TRAVERSE  
 WAS 1:21,352 AND WAS NOT ADJUSTED.  
 THE SURVEY SHOWN HEREON IS A RURAL SURVEY  
 AND MEETS OR EXCEEDS THE SPECIFICATIONS OF THIS CLASS.

*Stephen R. Wurzel 7-20-15*  
 STEPHEN R. WURZEL P.L.S. # 3018  
 NOTE: SUBJECT TO ALL EASEMENTS AND RIGHT OF  
 WAYS WHETHER SHOWN OR NOT.

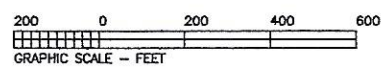

PLANNING COMMISSION NOTE

This boundary survey is not a subdivision plat and has not  
 been reviewed or approved as being in compliance with the  
 DEVELOPMENT GUIDANCE SYSTEM ordinance as  
 adopted by Hardin County Fiscal Court.  
 7-21-15  
 DATE Chairman of Director



**ADVANCED SURVEYS INC.**  
 ROADWAY & SUBDIVISION LAYOUT  
 ALL TYPES OF CONSTRUCTION LAYOUT  
 MORTGAGE INSPECTIONS  
 FARM & BOUNDARY SURVEYS  
 P.O. BOX 6705 SHEPHERDSVILLE, KY. 40165  
 (502) 543-3808

**BOUNDARY SURVEY**  
 FOR: STEPHEN & SUSAN WURZEL  
 270 DEATSVILLE ROAD  
 COXS CREEK, KY 40013  
 BEING A PORTION OF THE WURZEL PROPERTY RECORDED  
 DEED BOOK 815 PAGE 228 AND ALL OF DEED BOOK  
 833 PAGE 478 IN THE HARDIN COUNTY CLERK'S  
 OFFICE ELIZABETHTOWN, KENTUCKY.  
 DRAWN BY S.R.W. DATE 7-20-2015 SCALE 1" = 200'

THIS PLAT REPRESENTS A BOUNDARY SURVEY AND COMPLIES WITH 201 KAR 18.150